

Data Sheet

Itemnumber....: 3220800109

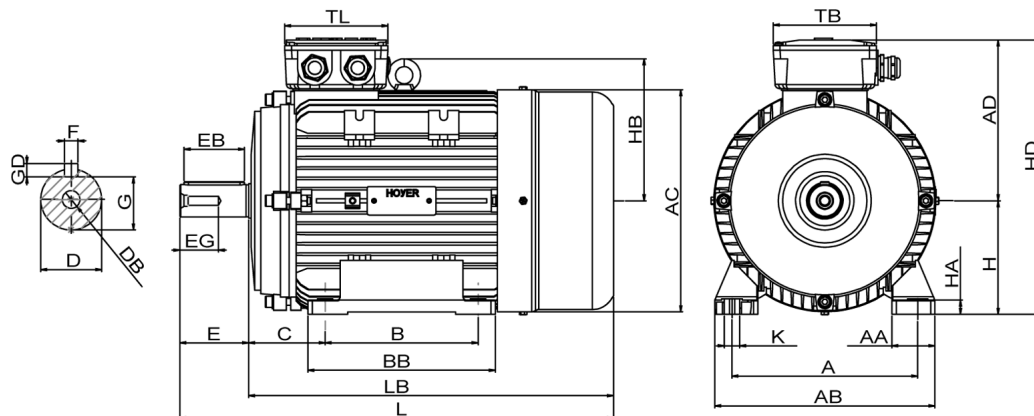

A = 125	AC = 159	BB = 122	DB = M6	EG = 16	GD = 6	HD = 206	LB = 254
AA = 27	AD = 126	C = 50	E = 40	F = 6	H = 80	K = 10	TB = 100
AB = 159	B = 100	D = 19	EB = 32	G = 15,50	HA = 12	L = 294	TL = 100

Version

Type.....: HMA2 80 1-2
Design.....: Induction motor
Standard series.....: IEC 60034
Phase / Voltage range.....: 3~ / Low

Electrical design

Efficiency.....: IE2
Pole.....: 2
Power at 50 Hz (kW).....: 0,75
Hz.....: 60 (60 Hz output)
Voltage.....: 440VY
Winding voltage.....: 230VD/400VY 50 Hz
Power output (kW).....: 0,87
Duty.....: S1
Insulation class.....: F
Temperature rise.....: B

Mechanical design

Frame size.....: 80
Mounting.....: B3
Rain cap.....: No
Protection class.....: IP55
Cooling method.....: IC411/TEFC
External grounding.....: Yes
Drain hole.....: Yes
Frame material.....: Aluminium
Material approval.....: None
Shaft.....: IEC Standard
Key.....: Closed key
Balancing.....: Half key balancing
Vibration class.....: Grade-A
Weight (kg).....: 9,00

Environment condition

Ambient temp. min. (°C)....: -20
Ambient temp. max. (°C)....: 45
Altitude (mtr up to).....: 1000

Bearing

DE Bearing.....: 6204-ZZ/C3
NDE Bearing.....: 6204-ZZ/C3
Fixed bearing.....: DE

Terminal box

Tbox position.....: Top
Cable entry direction.....: Right (from DE)
Cable entry
Main.....: 1 x M20x1,5
Ø8-13mm metal
Accessory.....: 1 x M20x1,5
Metal blindcap
Terminal board thread.....: 6-M4

Test values

Rotor inertia (kgm²).....: 0,00098
Noise level (dB(A)).....: 62
No load current (A).....: 1,08
Winding resist. (ohm).....: 8,98
Starting time (sec.).....: 0,00
Temp. rise winding (K).....: 44
Temp. rise surface (K).....: 43

Motor protection

Thermal protection main....: PTC 3x 155 dgr
Thermal protection second..: None
Space heater.....: None
Temperature detector.....: No
SPM.....: No
IR wire.....: No
Tropical insulation.....: Yes

Explosion protection

According to.....: None
Type of protection.....: None

General

Direction of rotation.....: CW
Painting.....: RAL 9005
Nameplate.....: Multivoltage + VFD
Special packing.....: No
Special requirements.....: No

Rated power (kW)	0,75	0,73	0,90	0,87
Frequency (Hz)	50	50	60	60
Voltage (V)	230 400	220 380	280 480	440
Connection	D Y	D Y	D Y	Y
Full load current (A)	3,00 1,72	3,10 1,78	3,00 1,72	1,78
Speed (rpm)	2880	2880	3450	3450
Power factor cos(phi)	0,81	0,82	0,81	0,86
Efficiency, 100/75/50 (%) . .	77,4/ 77,7 /75,1	77,4/ 77,7 /75,1	77,4/ 77,7 /75,1	75,8/ 76,1 /73,4
Ist/In	6,65	5,85	6,65	6,10
Full load torque (Nm)	2,50	2,42	2,50	2,42
Tst/Tn	2,85	2,65	2,85	2,46
Tmax/Tn	3,00	2,80	3,00	2,60
Duty	S1	S1	S1	S1
Ambient temp. (°C)	40	45	40	45