

Data Sheet

Itemnumber....: 3221000109

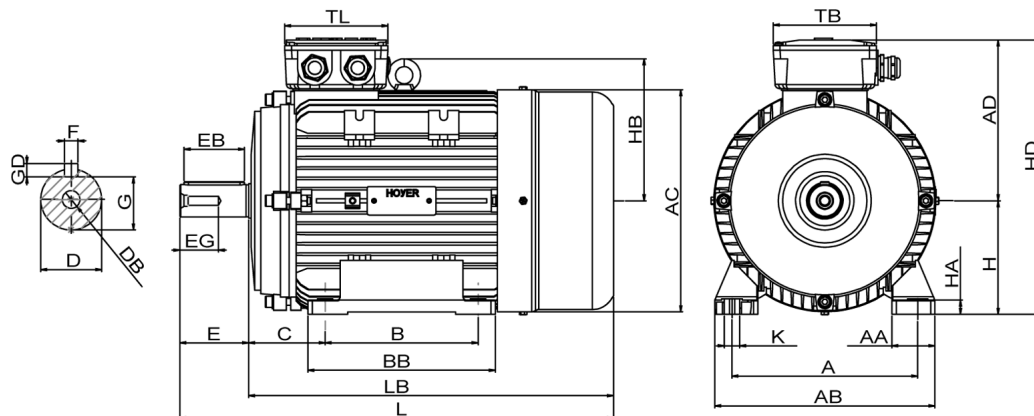

A = 160	AC = 198	BB = 176	DB = M10	EG = 28	GD = 7	HB = 135	L = 401	TL = 100
AA = 42	AD = 147	C = 63	E = 60	F = 8	H = 100	HD = 247	LB = 341	
AB = 205	B = 140	D = 28	EB = 50	G = 24	HA = 12	K = 12	TB = 100	

Version

Type.....: HMA2 100L-2
Design.....: Induction motor
Standard series.....: IEC 60034
Phase / Voltage range.....: 3~ / Low

Electrical design

Efficiency.....: IE2
Pole.....: 2
Power at 50 Hz (kW).....: 3,00
Hz.....: 60 (60 Hz output)
Voltage.....: 440VY
Winding voltage.....: 230VD/400VY 50 Hz
Power output (kW).....: 3,50
Duty.....: S1
Insulation class.....: F
Temperature rise.....: B

Mechanical design

Frame size.....: 100
Mounting.....: B3
Rain cap.....: No
Protection class.....: IP55
Cooling method.....: IC411/TEFC
External grounding.....: Yes
Drain hole.....: Yes
Frame material.....: Aluminium
Material approval.....: None
Shaft.....: IEC Standard
Key.....: Closed key
Balancing.....: Half key balancing
Vibration class.....: Grade-A
Weight (kg).....: 23,0

Environment condition

Ambient temp. min. (°C)..: -20
Ambient temp. max. (°C)..: 45
Altitude (mtr up to).....: 1000

Bearing

DE Bearing.....: 6206-ZZ/C3
NDE Bearing.....: 6206-ZZ/C3
Fixed bearing.....: DE

Terminal box

Tbox position.....: Top
Cable entry direction.....: Right (from DE)
Cable entry
Main.....: 1 x M20x1,5
Ø8-13mm metal
Accessory.....: 1 x M20x1,5
Metal blindcap
Terminal board thread.....: 6-M4

Test values

Rotor inertia (kgm²).....: 0,0041
Noise level (dB(A)).....: 69
No load current (A).....: 2,42
Winding resist. (ohm).....: 1,57
Starting time (sec.).....: 0,00
Temp. rise winding (K).....: 59
Temp. rise surface (K).....: 40

Motor protection

Thermal protection main....: PTC 3x 155 dgr
Thermal protection second..: None
Space heater.....: None
Temperature detector.....: No
SPM.....: No
IR wire.....: No
Tropical insulation.....: Yes

Explosion protection

According to.....: None
Type of protection.....: None

General

Direction of rotation.....: CW
Painting.....: RAL 9005
Nameplate.....: Multivoltage + VFD
Special packing.....: No
Special requirements.....: No

Rated power (kW)	3,00	2,90	3,60	3,50
Frequency (Hz)	50	50	60	60
Voltage (V)	230 400	220 380	280 480	440
Connection	D Y	D Y	D Y	Y
Full load current (A)	10,2 5,80	10,4 6,00	10,2 5,80	6,00
Speed (rpm)	2900	2900	3490	3490
Power factor cos(phi)	0,88	0,89	0,88	0,86
Efficiency, 100/75/50 (%)	84,6/ 85,0 /83,5	84,6/ 85,0 /83,5	84,6/ 85,0 /83,5	83,8/ 84,2 /82,7
Ist/In	8,75	7,70	8,75	8,05
Full load torque (Nm)	9,85	9,55	9,85	9,55
Tst/Tn	3,15	2,90	3,15	2,70
Tmax/Tn	3,90	3,65	3,90	3,40
Duty	S1	S1	S1	S1
Ambient temp. (°C)	40	45	40	45