

# Data Sheet

Itemnumber..... 3221601159

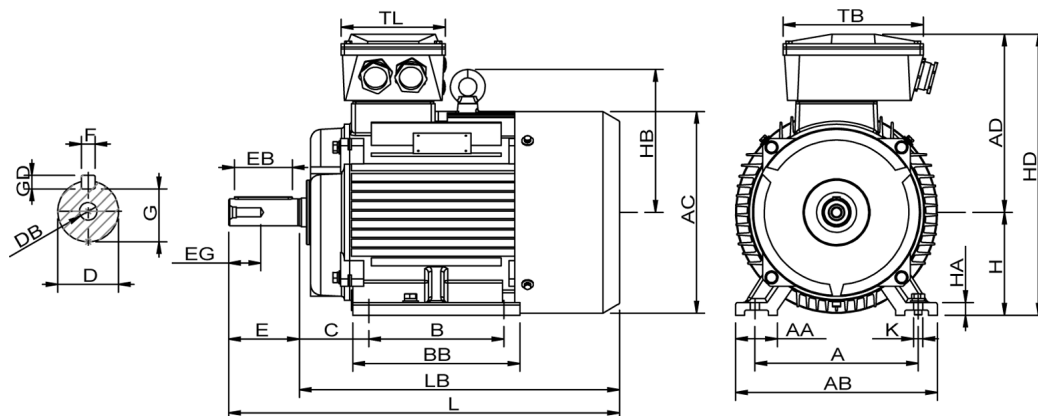

|          |          |          |          |         |         |           |          |          |
|----------|----------|----------|----------|---------|---------|-----------|----------|----------|
| A = 254  | AC = 313 | BB = 260 | DB = M16 | EG = 36 | GD = 8  | HB = 222  | L = 608  | TL = 162 |
| AA = 65  | AD = 277 | C = 108  | E = 110  | F = 12  | H = 160 | HD = 437  | LB = 498 |          |
| AB = 314 | B = 210  | D = 42   | EB = 90  | G = 37  | HA = 20 | K = 14,50 | TB = 218 |          |

## Version

Type..... HMC2 160M2-2  
Design..... Induction motor  
Standard series..... IEC 60034  
Phase / Voltage range..... 3~ / Low

## Electrical design

Efficiency..... IE2  
Pole..... 2  
Power at 50 Hz (kW)..... 15,0  
Hz..... 60 (60 Hz output)  
Voltage..... 440VY  
Winding voltage..... 230VD/400VY 50 Hz  
Power output (kW)..... 17,4  
Duty..... S1  
Insulation class..... F  
Temperature rise..... B

## Mechanical design

Frame size..... 160  
Mounting..... B3  
Rain cap..... No  
Protection class..... IP55  
Cooling method..... IC411/TEFC  
External grounding..... Yes  
Drain hole..... Yes  
Frame material..... Cast Iron  
Material approval..... None  
Shaft..... IEC Standard  
Key..... Closed key  
Balancing..... Half key balancing  
Vibration class..... Grade-A  
Weight (kg)..... 119

## Environment condition

Ambient temp. min. (°C)..... -20  
Ambient temp. max. (°C)..... 45  
Altitude (mtr up to)..... 1000

## Bearing

DE Bearing..... 6309-ZZ/C3  
NDE Bearing..... 6309-ZZ/C3  
Fixed bearing..... DE

## Terminal box

Tbox position..... Top  
Cable entry direction..... Right (from DE)  
Cable entry  
Main..... 2 x M40x1,5  
Ø22-30mm metal  
Accessory..... 2 x M20x1,5  
Metal blindcaps  
Terminal board thread..... 6-M6

## Test values

Rotor inertia (kgm²)..... 0,053  
Noise level (dB(A))..... 74  
No load current (A)..... 7,10  
Winding resist. (ohm)..... 0,14  
Starting time (sec.)..... 0,14  
Temp. rise winding (K)..... 65  
Temp. rise surface (K)..... 38

## Motor protection

Thermal protection main..... PTC 3x 155 dgr  
Thermal protection second..: None  
Space heater..... 1x 230V 50W  
Temperature detector..... No  
SPM..... No  
IR wire..... No  
Tropical insulation..... Yes

## Explosion protection

According to..... None  
Type of protection..... None

## General

Direction of rotation..... CW  
Painting..... RAL 9005  
Nameplate..... Multivoltage + VFD  
Special packing..... No  
Special requirements..... No

|                           |                  |                  |                  |                  |
|---------------------------|------------------|------------------|------------------|------------------|
| Rated power (kW)          | 15,0             | 14,6             | 18,0             | 17,4             |
| Frequency (Hz)            | 50               | 50               | 60               | 60               |
| Voltage (V)               | 230 400          | 220 380          | 280 480          | 440              |
| Connection                | D Y              | D Y              | D Y              | Y                |
| Full load current (A)     | 45,0 26,0        | 46,5 27,0        | 45,0 26,0        | 27,5             |
| Speed (rpm)               | 2940             | 2940             | 3520             | 3520             |
| Power factor cos(phi)     | 0,92             | 0,93             | 0,92             | 0,93             |
| Efficiency, 100/75/50 (%) | 90,3/ 89,4 /88,8 | 90,3/ 89,4 /88,8 | 90,3/ 89,4 /88,8 | 89,8/ 88,9 /88,2 |
| Ist/In                    | 7,25             | 6,35             | 7,25             | 6,65             |
| Full load torque (Nm)     | 48,5             | 47,0             | 48,5             | 47,0             |
| Tst/Tn                    | 2,50             | 2,32             | 2,50             | 2,16             |
| Tmax/Tn                   | 3,45             | 3,20             | 3,45             | 2,95             |
| Duty                      | S1               | S1               | S1               | S1               |
| Ambient temp. (°C)        | 40               | 45               | 40               | 45               |