

Data Sheet

Itemnumber....: 3240711108

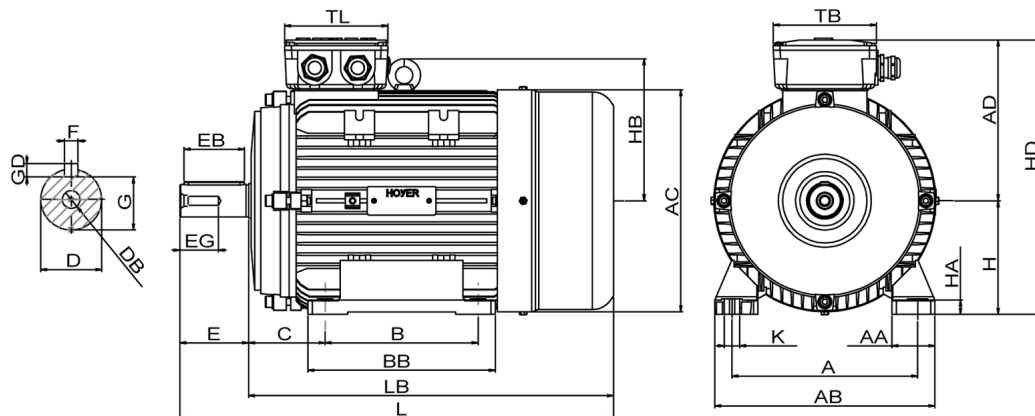

A = 112	AC = 139	BB = 113	DB = M5	EG = 13	GD = 5	HD = 184	LB = 219
AA = 24	AD = 113	C = 45	E = 30	F = 5	H = 71	K = 7	TB = 80
AB = 138	B = 90	D = 14	EB = 22	G = 11	HA = 9,50	L = 249	TL = 80

Version

Type.....: HMA2 71 2-4
Design.....: Induction motor
Standard series.....: IEC 60034
Phase / Voltage range.....: 3~ / Low

Electrical design

Efficiency.....: IE2
Pole.....: 4
Power at 50 Hz (kW).....: 0,37
Hz.....: 60 (60 Hz output)
Voltage.....: 440VY
Winding voltage.....: 230VD/400VY 50 Hz
Power output (kW).....: 0,43
Duty.....: S1
Insulation class.....: F
Temperature rise.....: B

Mechanical design

Frame size.....: 71
Mounting.....: B3
Rain cap.....: No
Protection class.....: IP55
Cooling method.....: IC411/TEFC
External grounding.....: Yes
Drain hole.....: Yes
Frame material.....: Aluminium
Material approval.....: None
Shaft.....: IEC standard
Key.....: Closed key
Balancing.....: Half key balancing
Vibration class.....: Grade-A
Weight (kg).....: 6,50

Environment condition

Ambient temp. min. (°C)....: -20
Ambient temp. max. (°C)....: 45
Altitude (mtr up to).....: 1000

Bearing

DE Bearing.....: 6202-ZZ/C3
NDE Bearing.....: 6202-ZZ/C3
Fixed bearing.....: DE

Terminal box

Tbox position.....: Top
Cable entry direction.....: Right (from DE)
Cable entry
Main.....: 1 x M20x1,5
Ø8-13mm metal
Accessory.....: 1 x M20x1,5
Metal blindcap
Terminal board thread.....: M4

Motor protection

Thermal protection main....: PTC 3x 155 dgr
Thermal protection second..: None
Space heater.....: None
Temperature detector.....: No
SPM.....: No
IR wire.....: No
Tropical insulation.....: Yes

Explosion protection

According to.....: None
Type of protection.....: None

General

Direction of rotation.....: CW
Painting.....: RAL 9005
Nameplate.....: Multivoltage + VFD
Special packing.....: No
Special requirements.....: No

Test values

Rotor inertia (kgm²).....: 0,0010
Noise level (dB(A)).....: 56
No load current (A).....: 0,72
Winding resist. (ohm).....: 18,2
Starting time (sec.).....: 0,00
Temp. rise winding (K).....: 36
Temp. rise surface (K).....: 21

Rated power (kW)	0,37	0,36	0,44	0,43
Frequency (Hz)	50	50	60	60
Voltage (V)	230 400	220 380	280 480	440
Connection	D Y	D Y	D Y	Y
Full load current (A)	1,80 1,04	1,86 1,08	1,80 1,04	1,08
Speed (rpm)	1380	1380	1660	1660
Power factor cos(phi)	0,71	0,72	0,71	0,76
Efficiency, 100/75/50 (%)	72,7/ 75,8 /74,9	72,7/ 75,8 /74,9	72,7/ 75,8 /74,9	70,8/ 74,1 /73,1
Ist/In	4,45	3,90	4,45	4,10
Full load torque (Nm)	2,55	2,48	2,55	2,48
Tst/Tn	2,75	2,55	2,75	2,36
Tmax/Tn	2,46	2,28	2,46	2,12
Duty	S1	S1	S1	S1
Ambient temp. (°C)	40	45	40	45