

Data Sheet

Itemnumber....: 3241320109

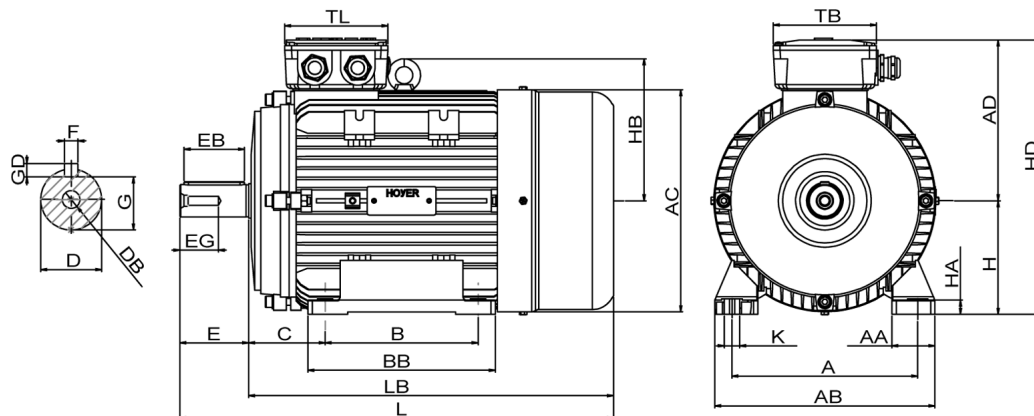

A = 216	AC = 258	BB = 180	DB = M12	EG = 30	GD = 8	HB = 165	L = 467	TL = 120
AA = 50	AD = 187	C = 89	E = 80	F = 10	H = 132	HD = 319	LB = 387	
AB = 256	B = 140	D = 38	EB = 70	G = 33	HA = 16,50	K = 12	TB = 120	

Version

Type.....: HMA2 132S-4
Design.....: Induction motor
Standard series.....: IEC 60034
Phase / Voltage range.....: 3~ / Low

Electrical design

Efficiency.....: IE2
Pole.....: 4
Power at 50 Hz (kW).....: 5,50
Hz.....: 60 (60 Hz output)
Voltage.....: 440VD
Winding voltage.....: 400VD/690VY 50 Hz
Power output (kW).....: 6,40
Duty.....: S1
Insulation class.....: F
Temperature rise.....: B

Mechanical design

Frame size.....: 132
Mounting.....: B3
Rain cap.....: No
Protection class.....: IP55
Cooling method.....: IC411/TEFC
External grounding.....: Yes
Drain hole.....: Yes
Frame material.....: Aluminium
Material approval.....: None
Shaft.....: IEC Standard
Key.....: Closed key
Balancing.....: Half key balancing
Vibration class.....: Grade-A
Weight (kg).....: 51,0

Environment condition

Ambient temp. min. (°C)....: -20
Ambient temp. max. (°C)....: 45
Altitude (mtr up to).....: 1000

Bearing

DE Bearing.....: 6308-ZZ/C3
NDE Bearing.....: 6308-ZZ/C3
Fixed bearing.....: DE

Terminal box

Tbox position.....: Top
Cable entry direction.....: Right (from DE)
Cable entry
Main.....: 2 x M25x1,5
 Ø11-17mm metal
Accessory.....: 1 x M20x1,5
 Metal blindcap
Terminal board thread.....: 6-M5

Motor protection

Thermal protection main....: PTC 3x 155 dgr
Thermal protection second..: None
Space heater.....: None
Temperature detector.....: No
SPM.....: No
IR wire.....: No
Tropical insulation.....: Yes

Explosion protection

According to.....: None
Type of protection.....: None

General

Direction of rotation.....: CW
Painting.....: RAL 9005
Nameplate.....: Multivoltage + VFD
Special packing.....: No
Special requirements.....: No

Test values

Rotor inertia (kgm²).....: 0,033
Noise level (dB(A)).....: 65
No load current (A).....: 4,95
Winding resist. (ohm).....: 2,26
Starting time (sec.).....: 0,00
Temp. rise winding (K).....: 72
Temp. rise surface (K).....: 59

Rated power (kW)	5,50	5,35	6,60	6,40
Frequency (Hz)	50	50	60	60
Voltage (V)	400 690	380 660	480 830	440
Connection	D Y	D Y	D Y	D
Full load current (A)	10,8 6,30	11,2 6,50	10,8 6,30	11,2
Speed (rpm)	1460	1460	1750	1750
Power factor cos(phi)	0,83	0,84	0,83	0,86
Efficiency, 100/75/50 (%)	87,7/ 88,2 /87,1	87,7/ 88,2 /87,1	87,7/ 88,2 /87,1	86,8/ 87,3 /86,2
Ist/In	7,85	6,90	7,85	7,25
Full load torque (Nm)	36,0	35,0	36,0	35,0
Tst/Tn	2,44	2,26	2,44	2,10
Tmax/Tn	2,80	2,60	2,80	2,42
Duty	S1	S1	S1	S1
Ambient temp. (°C)	40	45	40	45