

# Data Sheet

Itemnumber....: 3243150109

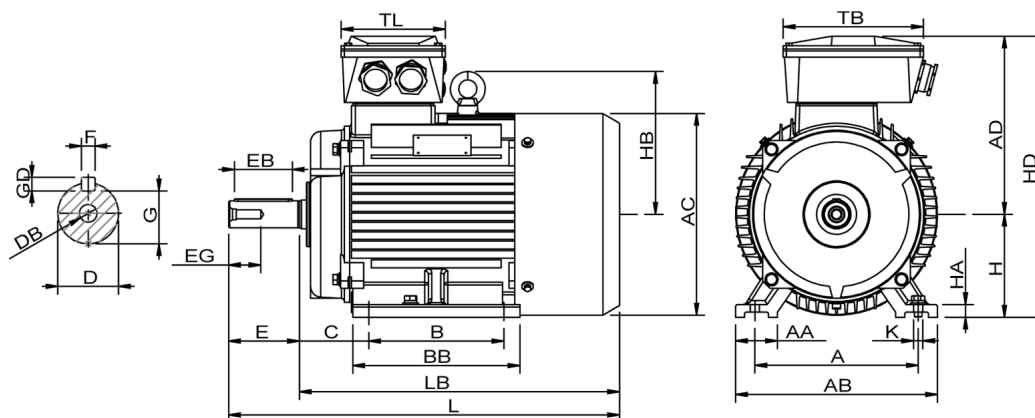

A = 508	AC = 620	BB = 570	DB = M20	EG = 56	GD = 14	HB = 432	L = 1208	TL = 280
AA = 120	AD = 546	C = 216	E = 170	F = 22	H = 315	HD = 861	LB = 1038	
AB = 628	B = 406	D = 80	EB = 140	G = 71	HA = 45	K = 28	TB = 400	

## Version

Type.....: HMC2 315S-4  
Design.....: Induction motor  
Standard series.....: IEC 60034  
Phase / Voltage range.....: 3~ / Low

## Electrical design

```

Efficiency.....: IE2
Pole.....: 4
Power at 50 Hz (kW).....: 110
Hz.....: 60 (60 Hz output)
Voltage.....: 440VD
Winding voltage.....: 400VD/690VY 50 Hz
Power output (kW).....: 128
Duty.....: S1
Insulation class.....: F
Temperature rise.....: B

```

## Mechanical design

```

Mechanical Design..... 315
Mounting..... B3
Rain cap..... No
Protection class..... IP55
Cooling method..... IC411/TEFC
External grounding..... Yes
Drain hole..... Yes
Frame material..... Cast Iron
Material approval..... None
Shaft..... IEC Standard
Key..... Closed key
Balancing..... Half key balancing
Vibration class..... Grade-A
Weight (kg)..... 840

```

## Environment condition

Ambient temp. min. (°C)...: -20  
Ambient temp. max. (°C)...: 45  
Altitude (mtr up to).....: 1000

### Motor protection

```

Thermal protection main....: PTC 3x 155 dgr
Thermal protection second..: None
Space heater.....: 1x 230V 100W
Temperature detector.....: No
SPM.....: No
IR wire.....: No
Tropical insulation.....: Yes

```

## Explosion protection

```

According to.....: None
Type of protection.....: None

```

## General

Direction of rotation.....: CW  
Painting.....: RAL 9005  
Nameplate.....: Multivoltage + VFD  
Special packing.....: No  
Special requirements.....: No

### Bearing

Bearing  
DE Bearing.....: 6319/C3  
NDE Bearing.....: 6319/C3  
Fixed bearing.....: DE

Terminal box

```

Thox position.....: Top
Cable entry direction.....: Right (from DE)
Cable entry
    Main.....: 2 x M63x1,5
                  Ø37-44mm metal
    Accessory.....: 2 x M20x1,5
                  Metal blindcaps
Terminal board thread.....: 6-M16

```

## Test values

```

Rotor inertia (kgm2).....: 2,87
Noise level (dB(A)).....: 81
No load current (A).....: 55,5
Winding resist. (ohm).....: 0,024
Starting time (sec.).....: 0,28
Temp. rise winding (K).....: 55
Temp. rise surface (K).....: 21

```

Rated power (kW)	110	106	132	128
Frequency (Hz)	50	50	60	60
Voltage (V)	400 690	380 660	480 830	440
Connection	D Y	D Y	D Y	D
Full load current (A)	190 110	196 114	190 110	198
Speed (rpm)	1490	1490	1780	1780
Power factor cos(phi)	0,89	0,89	0,89	0,90
Efficiency, 100/75/50 (%)	94,5/ 94,7 /93,9	94,5/ 94,7 /93,9	94,5/ 94,7 /93,9	94,1/ 94,3 /93,5
Ist/In	6,85	6,05	6,85	6,30
Full load torque (Nm)	705	685	705	685
Tst/Tn	2,50	2,32	2,50	2,16
Tmax/Tn	3,05	2,80	3,05	2,60
Duty	S1	S1	S1	S1
Ambient temp. (°C)	40	45	40	45