

Data Sheet

Itemnumber....: 3261321109

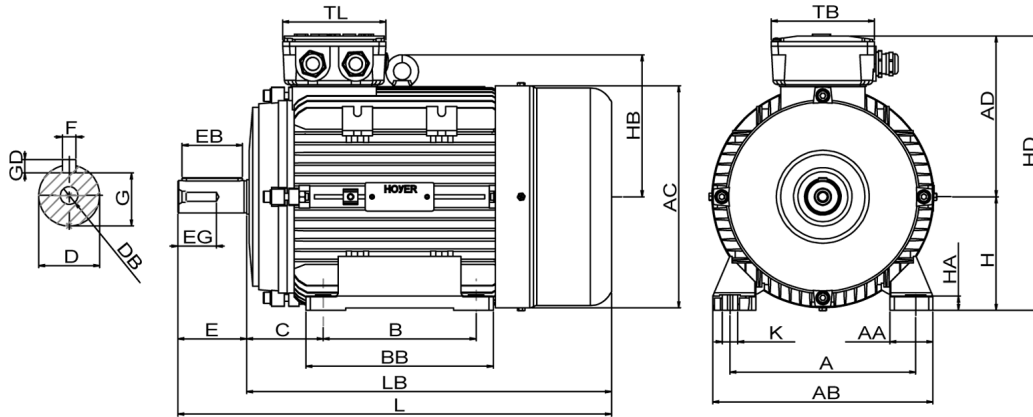

A = 216	AC = 258	BE = 218	DB = M12	EG = 30	GD = 8	HB = 165	L = 505	TL = 120
AA = 50	AD = 187	C = 89	E = 80	F = 10	H = 132	HD = 319	LB = 425	
AB = 256	B = 178	D = 38	EB = 70	G = 33	HA = 16,50	K = 12	TB = 120	

Version

Type.....: HMA2 132M1-6
Design.....: Induction motor
Standard series.....: IEC 60034
Phase / Voltage range.....: 3~ / Low

Electrical design

```

Efficiency..... IE2
Pole..... 6
Power at 50 Hz (kW)..... 4,00
Hz..... 60 (60 Hz output)
Voltage..... 440VD
Winding voltage..... 400VD/690VY 50 Hz
Power output (kW)..... 4,65
Duty..... S1
Insulation class..... F
Temperature rise..... B

```

Mechanical design

Frame size.....	132
Mounting.....	B3
Rain cap.....	No
Protection class.....	IP55
Cooling method.....	IC411/TEFC
External grounding.....	Yes
Drain hole.....	Yes
Frame material.....	Aluminium
Material approval.....	None
Shaft.....	IEC Standard
Key.....	Closed key
Balancing.....	Half key balancing
Vibration class.....	Grade-A
Weight (kg).....	61,0

Environment condition

```
Ambient temp. min. (°C)..: -20
Ambient temp. max. (°C)..: 45
Altitude (mtr up to).....: 1000
```

Bearing

DE Bearing.....: 6308-ZZ/C3
NDE Bearing.....: 6308-ZZ/C3
Fixed bearing.....: DE

Terminal box

```
Tbox position.....: Top
Cable entry direction.....: Right (from DE)
Cable entry
  Main.....: 2 x M25x1,5
               Ø11-17mm metal
  Accessory.....: 1 x M20x1,5
                  Metal blindcap
Terminal board thread.....: M-M5
```

Test values

```

Rotor inertia (kgm2).....: 0,044
Noise level (dB(A)).....: 63
No load current (A).....: 5,25
Winding resist. (ohm).....: 3,51
Starting time (sec.).....: 0,00
Temp. rise winding (K).....: 62
Temp. rise surface (K).....: 54

```

Motor protection

```

Thermal protection main....: PTC 3x 155 dgr
Thermal protection second..: None
Space heater.....: None
Temperature detector.....: No
SPM.....: No
IR wire.....: No
Tropical insulation.....: Yes

```

Explosion protection

```
According to.....: None
Type of protection.....: None
```

General

Direction of rotation.....: CW
Painting.....: RAL 9005
Nameplate.....: Multivoltage + VFD
Special packing.....: No
Special requirements.....: No

Rated power (kW)	4,00	3,90	4,80	4,65
Frequency (Hz)	50	50	60	60
Voltage (V)	400 690	380 660	480 830	440
Connection	D Y	D Y	D Y	D
Full load current (A) . . .	8,85 5,15	9,15 5,30	8,85 5,15	9,15
Speed (rpm)	970	970	1170	1170
Power factor cos(phi) . . .	0,77	0,78	0,77	0,75
Efficiency, 100/75/50 (%) :	84,6/ 84,6 /82,5	84,6/ 84,6 /82,5	84,6/ 84,6 /82,5	83,5/ 83,5 /81,2
Ist/In	7,15	6,30	7,15	6,60
Full load torque (Nm) . . .	39,5	38,0	39,5	38,0
Tst/Tn	2,08	1,94	2,08	1,80
Tmax/Tn	2,50	2,32	2,50	2,16
Duty	S1	S1	S1	S1
Ambient temp. (°C)	40	45	40	45