

Data Sheet

Itemnumber.....: 6020900200

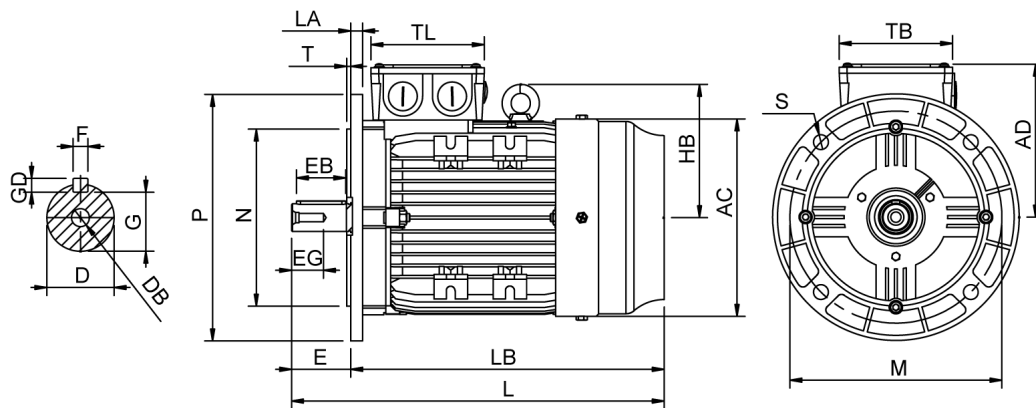

| | | | | | | |
|----------|---------|---------|---------|----------|-----------|----------|
| AC = 175 | DB = M8 | EG = 24 | GD = 7 | LB = 274 | P = 200 | TB = 115 |
| AD = 146 | E = 50 | F = 8 | L = 324 | M = 165 | S = 4-Ø12 | TL = 115 |
| D = 24 | EB = 40 | G = 20 | LA = 10 | N = 130 | T = 3,50 | |

Version

Type.....: HMA4 90S-2
Design.....: Induction motor
Standard series.....: IEC 60034
Phase / Voltage range.....: 3~ / Low

Electrical design

Efficiency.....: IE4
Pole.....: 2
Power at 50 Hz (kW).....: 1,50
Hz.....: 50
Voltage.....: 230VD/400VY
Winding voltage.....: 230VD/400VY 50 Hz
Power output (kW).....: 1,50
Duty.....: S1
Insulation class.....: F
Temperature rise.....: B

Mechanical design

Frame size.....: 90
Mounting.....: B5
Rain cap.....: No
Protection class.....: IP55
Cooling method.....: IC411/TEFC
External grounding.....: Yes
Drain hole.....: Yes
Frame material.....: Aluminium
Material approval.....: None
Shaft.....: IEC standard
Key.....: Closed key
Balancing.....: Half key balancing
Vibration class.....: Grade-A
Weight (kg).....: 16,0

Environment condition

Ambient temp. min. (°C).....: -20
Ambient temp. max. (°C).....: 40
Altitude (mtr up to).....: 1000

Bearing

DE Bearing.....: 6205-ZZ/C3
NDE Bearing.....: 6204-ZZ/C3
Fixed bearing.....: DE

Terminal box

Tbox position.....: Top
Cable entry direction.....: Right (from DE)
Cable entry
Main.....: 2 x M25x1,5
Plastic blindcaps
Accessory.....: 1 x M20x1,5
Plastic blindcap
Terminal board thread.....: M5

Motor protection

Thermal protection main.....: PTC 3x 155 dgr
Thermal protection second.....: None
Space heater.....: None None
Temperature detector.....: No
SPM.....: No
IR wire.....: No
Tropical insulation.....: No

Explosion protection

According to.....: None
Type of protection.....: None

General

Direction of rotation.....: CW
Painting.....: RAL 9005
Nameplate.....: Multivoltage
Special packing.....: No
Special requirements.....: No

Test values

Rotor inertia (kgm²).....: 0,0020
Noise level (dB(A)).....: 60
Starting time (sec.).....: 0,04

| | | | | |
|---------------------------|----------------|----------------|----------------|----------------|
| Rated power (kW) | 1,50 | 1,46 | 1,80 | 1,74 |
| Frequency (Hz) | 50 | 50 | 60 | 60 |
| Voltage (V) | 230 400 | 220 380 | 280 480 | 440 |
| Connection | D Y | D Y | D Y | Y |
| Full load current (A) | 4,95 2,85 | 5,10 2,95 | 4,95 2,85 | 2,95 |
| Speed (rpm) | 2900 | 2900 | 3490 | 3490 |
| Power factor cos(phi) | 0,88 | 0,89 | 0,88 | 0,89 |
| Efficiency, 100/75/50 (%) | 86,5/87,3/87,3 | 86,5/87,3/87,3 | 86,5/87,3/87,3 | 85,6/86,4/86,4 |
| Ist/In | 8,80 | 7,75 | 8,80 | 8,10 |
| Full load torque (Nm) | 4,95 | 4,80 | 4,95 | 4,80 |
| Tst/Tn | 3,10 | 2,90 | 3,10 | 2,70 |
| Tmax/Tn | 3,70 | 3,45 | 3,70 | 3,20 |
| Duty | S1 | S1 | S1 | S1 |
| Ambient temp. (°C) | 40 | 45 | 40 | 45 |