

Data Sheet

Itemnumber..... 6041601400

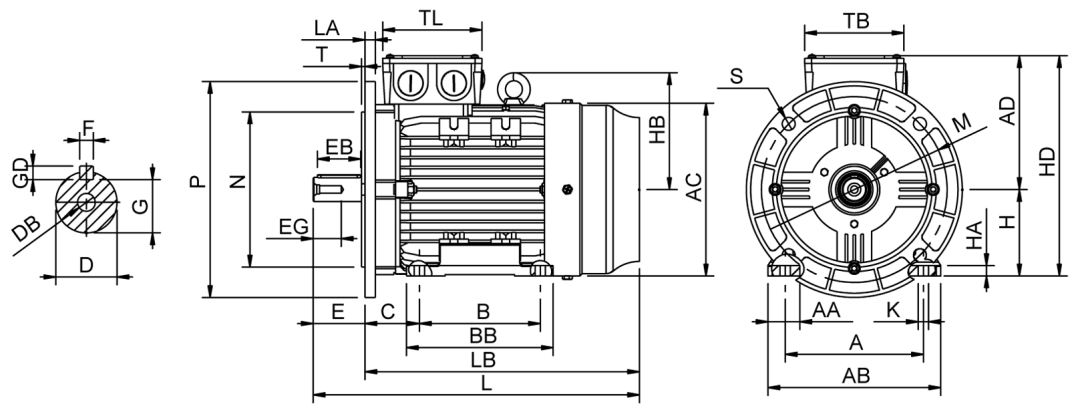

A = 254	AC = 314	BB = 304	DB = M16	EG = 38	GD = 8	HB = 207	L = 656	M = 300	S = 4-Ø18,5	TL = 181
AA = 62	AD = 238	C = 108	E = 110	F = 12	H = 160	HD = 398	LA = 15	N = 250	T = 5	
AB = 314	B = 254	D = 42	EB = 90	G = 37	HA = 22	K = 14,50	LB = 546	P = 350	TB = 181	

Version Type..... HMA4 160L-4 Design..... Induction motor Standard series..... IEC 60034 Phase / Voltage range..... 3~ / Low	Mechanical design Frame size..... 160 Mounting..... B35 Rain cap..... No Protection class..... IP55 Cooling method..... IC411/TEFC External grounding..... Yes Drain hole..... Yes Frame material..... Aluminium Material approval..... None Shaft..... IEC standard Key..... Closed key Balancing..... Half key balancing Vibration class..... Grade-A Weight (kg)..... 124	Bearing DE Bearing..... 6209-ZZ/C3 NDE Bearing..... 6209-ZZ/C3 Fixed bearing..... DE
Electrical design Efficiency..... IE4 Pole..... 4 Power at 50 Hz (kW)..... 15,0 Hz..... 50 Voltage..... 400VD/690VY Winding voltage..... 400VD/690VY 50 Hz Power output (kW)..... 15,0 Duty..... S1 Insulation class..... F Temperature rise..... B	Environment condition Ambient temp. min. (°C).. -20 Ambient temp. max. (°C).. 40 Altitude (mtr up to)..... 1000	Terminal box Tbox position..... Top Cable entry direction..... Right (from DE) Cable entry Main..... 2 x M40x1,5 Plastic blindcaps Accessory..... 2 x M20x1,5 Plastic blindcaps Terminal board thread..... M6
Motor protection Thermal protection main.... PTC 3x 155 dgr Thermal protection second.. None Space heater..... None None Temperature detector..... No SPM..... No IR wire..... No Tropical insulation..... No		Test values Rotor inertia (kgm²)..... 0,13 Noise level (dB(A))..... 64 Starting time (sec.)..... 0,07
Explosion protection According to..... None Type of protection..... None		

General
Direction of rotation..... CW
Painting..... RAL 9005
Nameplate..... Multivoltage
Special packing..... No
Special requirements..... No

Rated power (kW)	15,0	14,6	18,0	17,4
Frequency (Hz)	50	50	60	60
Voltage (V)	400 690	380 660	480 830	440
Connection	D Y	D Y	D Y	D
Full load current (A)	28,0 16,2	28,5 16,6	28,0 16,2	28,5
Speed (rpm)	1480	1480	1770	1770
Power factor cos(phi)	0,83	0,84	0,83	0,85
Efficiency, 100/75/50 (%) . .	93,9/93,8/92,9	93,9/93,8/92,9	93,9/93,8/92,9	93,5/93,4/92,4
Ist/In	9,00	7,90	9,00	8,30
Full load torque (Nm)	97,0	94,0	97,0	94,0
Tst/Tn	3,60	3,35	3,60	3,10
Tmax/Tn	3,80	3,55	3,80	3,30
Duty	S1	S1	S1	S1
Ambient temp. (°C)	40	45	40	45