

Data Sheet

Itemnumber.....: 6041800400

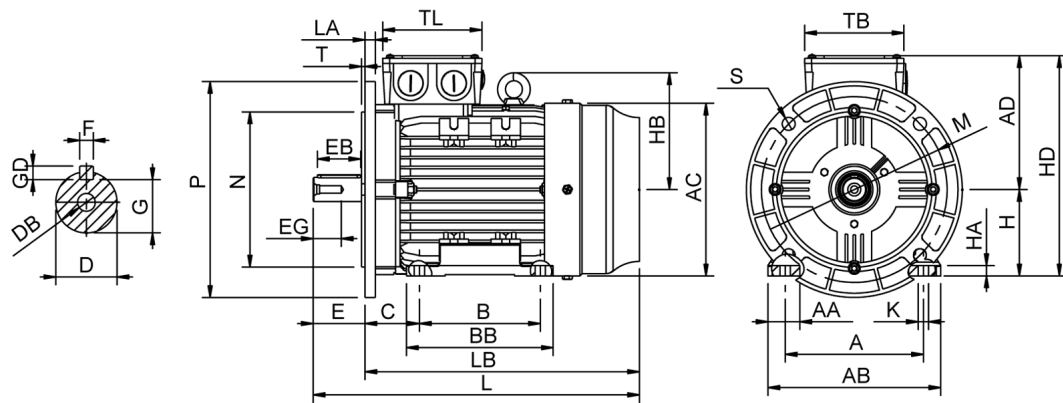

A = 279	AC = 355	BB = 304	DB = M16	EG = 42	GD = 9	HB = 227	L = 685	M = 300	S = 4-Ø18,5	TL = 181
AA = 70	AD = 256	C = 121	E = 110	F = 14	H = 180	HD = 436	LA = 15	N = 250	T = 5	
AB = 347	B = 241	D = 48	EB = 100	G = 42,50	HA = 25	K = 14,50	LB = 575	P = 350	TB = 181	

Version

Type.....: HMA4 180M-4
Design.....: Induction motor
Standard series.....: IEC 60034
Phase / Voltage range.....: 3~ / Low

Electrical design

Efficiency.....: IE4
Pole.....: 4
Power at 50 Hz (kW).....: 18,5
Hz.....: 50
Voltage.....: 400VD/690VY
Winding voltage.....: 400VD/690VY 50 Hz
Power output (kW).....: 18,5
Duty.....: S1
Insulation class.....: F
Temperature rise.....: B

Mechanical design

Frame size.....: 180
Mounting.....: B35
Rain cap.....: No
Protection class.....: IP55
Cooling method.....: IC411/TEFC
External grounding.....: Yes
Drain hole.....: Yes
Frame material.....: Aluminium
Material approval.....: None
Shaft.....: IEC standard
Key.....: Closed key
Balancing.....: Half key balancing
Vibration class.....: Grade-A
Weight (kg).....: 162

Environment condition

Ambient temp. min. (°C).....: -20
Ambient temp. max. (°C).....: 40
Altitude (mtr up to).....: 1000

Bearing

DE Bearing.....: 6311/C3
NDE Bearing.....: 6211/C3
Fixed bearing.....: DE

Terminal box

Tbox position.....: Top
Cable entry direction.....: Right (from DE)
Cable entry
Main.....: 2 x M40x1,5
Plastic blindcaps
Accessory.....: 2 x M20x1,5
Plastic blindcaps
Terminal board thread.....: M6

Test values

Rotor inertia (kgm²).....: 0,20
Noise level (dB(A)).....: 66
Starting time (sec.).....: 0,10

Motor protection

Thermal protection main.....: PTC 3x 155 dgr
Thermal protection second..: None
Space heater.....: None None
Temperature detector.....: No
SPM.....: No
IR wire.....: No
Tropical insulation.....: No

Explosion protection

According to.....: None
Type of protection.....: None

General

Direction of rotation.....: CW
Painting.....: RAL 9005
Nameplate.....: Multivoltage
Special packing.....: No
Special requirements.....: No

Rated power (kW)	18,5	18,0	22,2	21,6
Frequency (Hz)	50	50	60	60
Voltage (V)	400 690	380 660	480 830	440
Connection	D Y	D Y	D Y	D
Full load current (A)	34,0 19,8	35,0 20,4	34,0 19,8	35,0
Speed (rpm)	1480	1480	1770	1770
Power factor cos(phi)	0,83	0,84	0,83	0,85
Efficiency, 100/75/50 (%)	94,2/ 94,0 /93,0	94,2/ 94,0 /93,0	94,2/ 94,0 /93,0	93,8/ 93,6 /92,5
Ist/In	7,90	6,95	7,90	7,25
Full load torque (Nm)	120	116	120	116
Tst/Tn	2,30	2,14	2,30	2,00
Tmax/Tn	3,80	3,55	3,80	3,30
Duty	S1	S1	S1	S1
Ambient temp. (°C)	40	45	40	45