

Data Sheet

Itemnumber.....: 6061601200

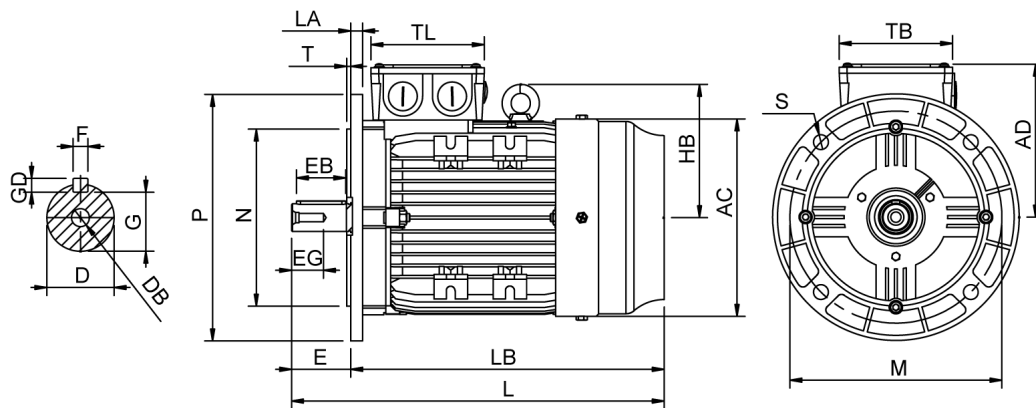

AC = 314	DB = M16	EG = 38	GD = 8	LA = 15	N = 250	T = 5
AD = 238	E = 110	F = 12	HB = 207	LB = 546	P = 350	TB = 181
D = 42	EB = 90	G = 37	L = 656	M = 300	S = 4-Ø18,5	TL = 181

Version

Type.....: HMA4 160L-6
Design.....: Induction motor
Standard series.....: IEC 60034
Phase / Voltage range.....: 3~ / Low

Electrical design

Efficiency.....: IE4
Pole.....: 6
Power at 50 Hz (kW).....: 11,0
Hz.....: 50
Voltage.....: 400VD/690VY
Winding voltage.....: 400VD/690VY 50 Hz
Power output (kW).....: 11,0
Duty.....: S1
Insulation class.....: F
Temperature rise.....: B

Mechanical design

Frame size.....: 160
Mounting.....: B5
Rain cap.....: No
Protection class.....: IP55
Cooling method.....: IC411/TEFC
External grounding.....: Yes
Drain hole.....: Yes
Frame material.....: Aluminium
Material approval.....: None
Shaft.....: IEC standard
Key.....: Closed key
Balancing.....: Half key balancing
Vibration class.....: Grade-A
Weight (kg).....: 150

Environment condition

Ambient temp. min. (°C)....: -20
Ambient temp. max. (°C)....: 40
Altitude (mtr up to).....: 1000

Bearing

DE Bearing.....: 6209-ZZ/C3
NDE Bearing.....: 6209-ZZ/C3
Fixed bearing.....: DE

Terminal box

Tbox position.....: Top
Cable entry direction.....: Right (from DE)
Cable entry
Main.....: 2 x M40x1,5
Plastic blindcaps
Accessory.....: 2 x M20x1,5
Plastic blindcaps
Terminal board thread.....: M6

Test values

Rotor inertia (kgm²).....: 0,26
Noise level (dB(A)).....: 56
Starting time (sec.).....: 0,10

Motor protection

Thermal protection main....: PTC 3x 155 dgr
Thermal protection second..: None
Space heater.....: None None
Temperature detector.....: No
SPM.....: No
IR wire.....: No
Tropical insulation.....: No

Explosion protection

According to.....: None
Type of protection.....: None

General

Direction of rotation.....: CW
Painting.....: RAL 9005
Nameplate.....: Multivoltage
Special packing.....: No
Special requirements.....: No

Rated power (kW)	11,0	10,6	13,2	12,8
Frequency (Hz)	50	50	60	60
Voltage (V)	400 690	380 660	480 830	440
Connection	D Y	D Y	D Y	D
Full load current (A)	23,0 13,2	23,6 13,6	23,0 13,2	23,6
Speed (rpm)	980	980	1170	1170
Power factor cos(phi)	0,75	0,76	0,75	0,78
Efficiency, 100/75/50 (%)	92,3/92,2/91,1	92,3/92,2/91,1	92,3/92,2/91,1	91,8/91,7/90,5
Ist/In	7,00	6,15	7,00	6,45
Full load torque (Nm)	108	104	108	104
Tst/Tn	3,00	2,80	3,00	2,60
Tmax/Tn	3,10	2,90	3,10	2,70
Duty	S1	S1	S1	S1
Ambient temp. (°C)	40	45	40	45