

# Data Sheet

Itemnumber.....: 6061800200

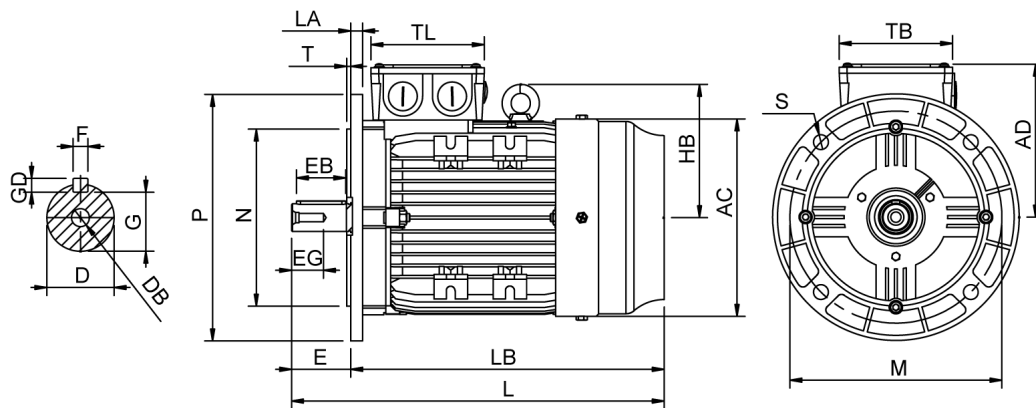

AC = 355	DB = M16	EG = 42	GD = 9	LA = 15	N = 250	T = 5
AD = 256	E = 110	F = 14	HB = 227	LB = 613	P = 350	TB = 181
D = 48	EB = 100	G = 42,50	L = 723	M = 300	S = 4-Ø18,5	TL = 181

## Version

Type.....: HMA4 180L-6  
Design.....: Induction motor  
Standard series.....: IEC 60034  
Phase / Voltage range.....: 3~ / Low

## Electrical design

Efficiency.....: IE4  
Pole.....: 6  
Power at 50 Hz (kW).....: 15,0  
Hz.....: 50  
Voltage.....: 400VD/690VY  
Winding voltage.....: 400VD/690VY 50 Hz  
Power output (kW).....: 15,0  
Duty.....: S1  
Insulation class.....: F  
Temperature rise.....: B

## Mechanical design

Frame size.....: 180  
Mounting.....: B5  
Rain cap.....: No  
Protection class.....: IP55  
Cooling method.....: IC411/TEFC  
External grounding.....: Yes  
Drain hole.....: Yes  
Frame material.....: Aluminium  
Material approval.....: None  
Shaft.....: IEC standard  
Key.....: Closed key  
Balancing.....: Half key balancing  
Vibration class.....: Grade-A  
Weight (kg).....: 170

## Environment condition

Ambient temp. min. (°C).....: -20  
Ambient temp. max. (°C).....: 40  
Altitude (mtr up to).....: 1000

## Bearing

DE Bearing.....: 6311/C3  
NDE Bearing.....: 6211/C3  
Fixed bearing.....: DE

## Terminal box

Tbox position.....: Top  
Cable entry direction.....: Right (from DE)  
Cable entry  
Main.....: 2 x M40x1,5  
Plastic blindcaps  
Accessory.....: 2 x M20x1,5  
Plastic blindcaps  
Terminal board thread.....: M6

## Test values

Rotor inertia (kgm²).....: 0,38  
Noise level (dB(A)).....: 59  
Starting time (sec.).....: 0,10

## Motor protection

Thermal protection main.....: PTC 3x 155 dgr  
Thermal protection second.....: None  
Space heater.....: None None  
Temperature detector.....: No  
SPM.....: No  
IR wire.....: No  
Tropical insulation.....: No

## Explosion protection

According to.....: None  
Type of protection.....: None

## General

Direction of rotation.....: CW  
Painting.....: RAL 9005  
Nameplate.....: Multivoltage  
Special packing.....: No  
Special requirements.....: No

Rated power (kW)	15,0	14,6	18,0	17,4
Frequency (Hz)	50	50	60	60
Voltage (V)	400 690	380 660	480 830	440
Connection	D Y	D Y	D Y	D
Full load current (A)	30,0 17,4	31,0 17,8	30,0 17,4	31,0
Speed (rpm)	980	980	1180	1180
Power factor cos(phi)	0,78	0,79	0,78	0,80
Efficiency, 100/75/50 (%)	92,9/ 92,7 /90,7	92,9/ 92,7 /90,7	92,9/ 92,7 /90,7	92,4/ 92,2 /90,0
Ist/In	8,50	7,50	8,50	7,80
Full load torque (Nm)	146	142	146	142
Tst/Tn	3,00	2,80	3,00	2,60
Tmax/Tn	3,40	3,15	3,40	2,95
Duty	S1	S1	S1	S1
Ambient temp. (°C)	40	45	40	45