

Speed sensor port
M12x1

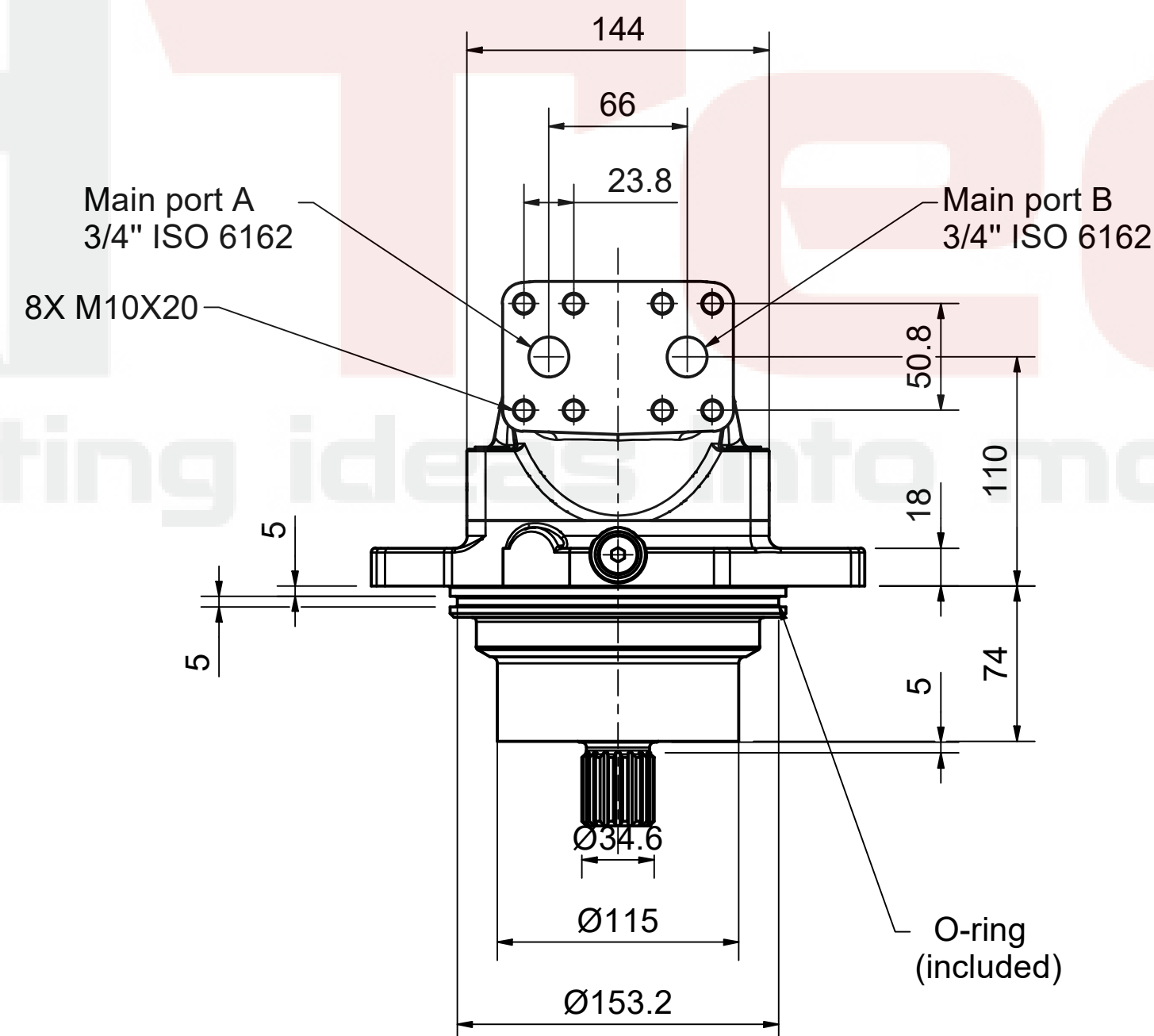

Disclaimer:
Parker PMDE has a continuous policy of product development and although the Company reserves the right to change specifications, it attempts to keep customers informed of any alterations. This publication is for general information only and customers are requested to contact their local Parker dealer for detailed information and advice on a products suitability for specific applications. All products are sold subject to the company's standard conditions of sale.

F12-060-MF-CV-B-000-0000-P0

F12-060



Pump & Motor Division Europe



F11 Motor



F12 Motor

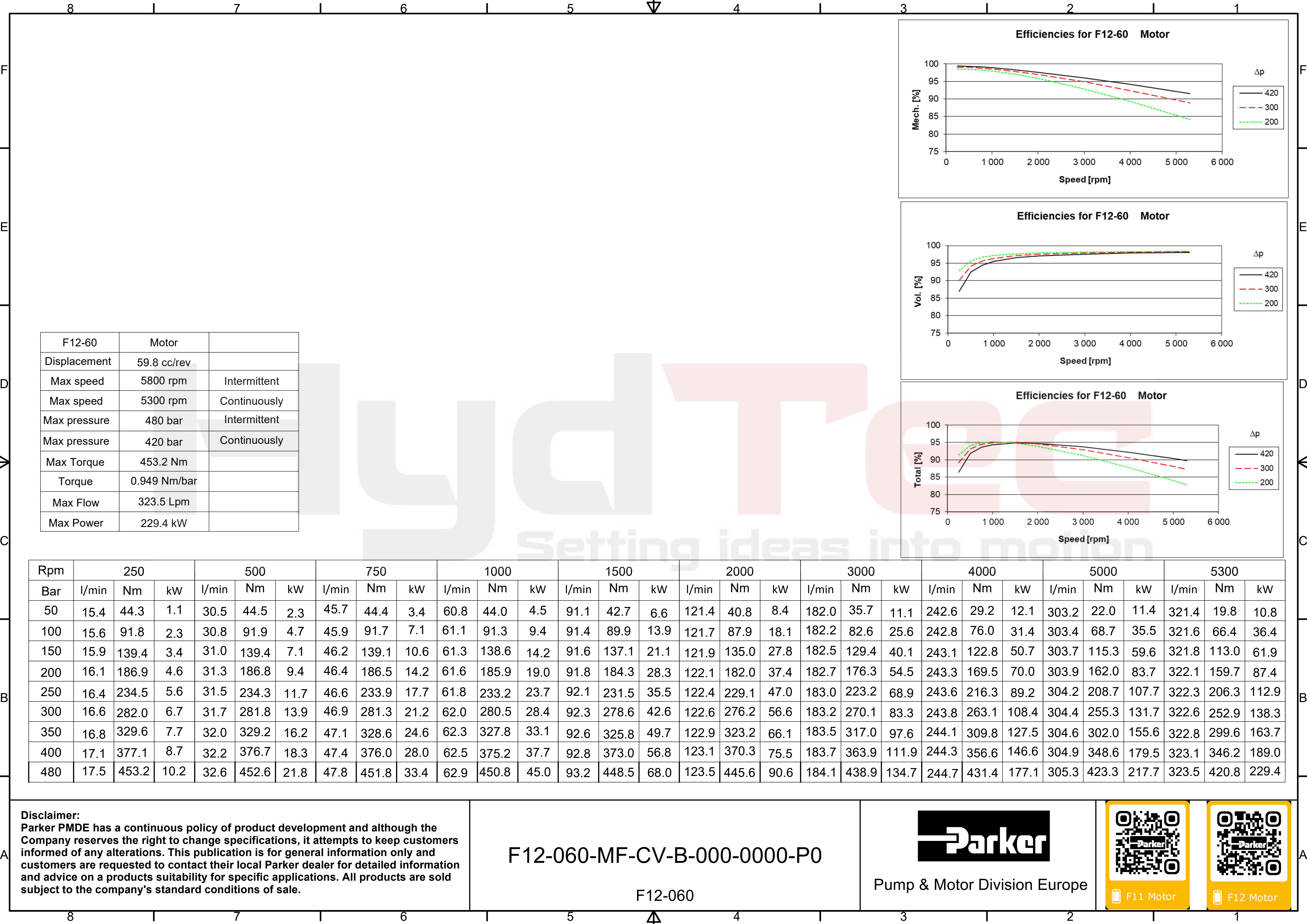

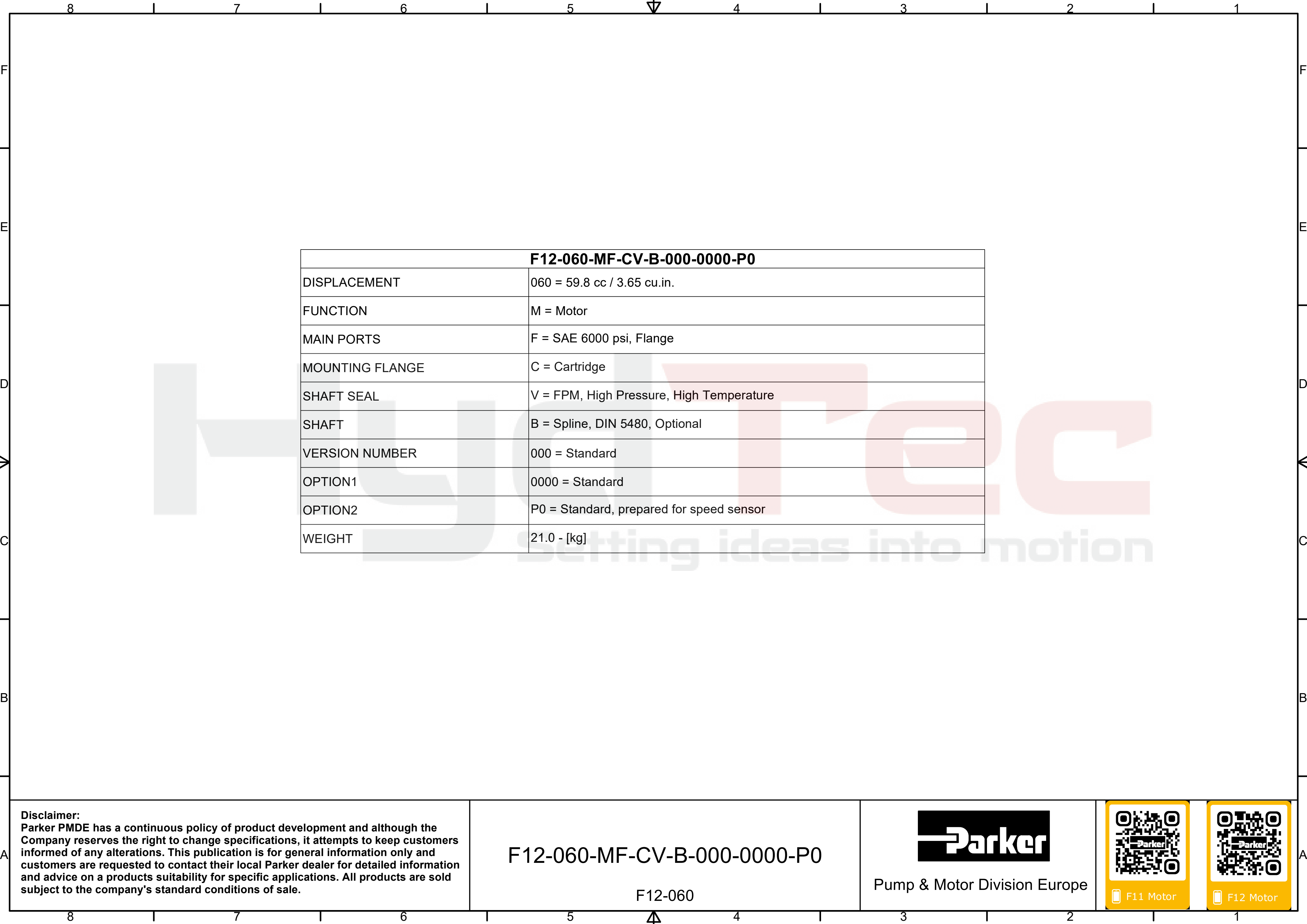

F12-060-MF-CV-B-000-0000-P0	
DISPLACEMENT	060 = 59.8 cc / 3.65 cu.in.
FUNCTION	M = Motor
MAIN PORTS	F = SAE 6000 psi, Flange
MOUNTING FLANGE	C = Cartridge
SHAFT SEAL	V = FPM, High Pressure, High Temperature
SHAFT	B = Spline, DIN 5480, Optional
VERSION NUMBER	000 = Standard
OPTION1	0000 = Standard
OPTION2	P0 = Standard, prepared for speed sensor
WEIGHT	21.0 - [kg]

Disclaimer:
Parker PMDE has a continuous policy of product development and although the Company reserves the right to change specifications, it attempts to keep customers informed of any alterations. This publication is for general information only and customers are requested to contact their local Parker dealer for detailed information and advice on a products suitability for specific applications. All products are sold subject to the company's standard conditions of sale.

F12-060-MF-CV-B-000-0000-P0

F12-060



Pump & Motor Division Europe



F11 Motor



F12 Motor